

# Universal Post and Platform Mount



*Productivity Through Control*

# Post & Platform

*Scientific breakthroughs are built on solid foundations and precision at every step. Eliminating environmental interference through vibrations and other sources is of paramount importance in the scientific experiment. Now you can have greater stability and precision with Scientifica's Universal Post and Platform, a stable and accurate mounting base for manipulators and other precision devices.*

*The most accurate equipment in the world is only as good as the base it sits on. So why build on sand and gamble with your results? Instead, choose Scientifica's Universal Post and Platform Mount for reliability and peace of mind.*

## Stable

Use Scientifica's Universal Post and Platform alongside any upright or inverted microscope for absolute precision.

Constructed of stainless steel and aluminium, this sturdy post weighs 8.8kg with the portable magnetic base attached. Exploiting three powerful magnets, each with 75kg holding force, this base will anchor firmly to any ferromagnetic surface. We also offer a model with a precision-tapped screw-down base for fixed mounting and total rigidity. Either attachment ensures a rock solid base that can resist environmental interference in your experiments.



# Universal Post & Platform

# Consistent

Repetition is an inevitable part of lab work. The mechanical stops on the horizontal axis and height adjustable collar of the Universal Post & Platform Mount combine to help you achieve complete replication of position.

No matter how often you swing the device away from the experimental area, our unique mechanical memory returns to exactly the same position time after time.

Scientifica's Post & Platform Mount delivers absolute precision throughout its extended lifetime. Simple, rugged engineering means it will work perfectly for years to come.

# Flexible

Both height and horizontal angle of the platform are fully and independently adjustable, and every moving part features a sturdy quick-release lock. Just twist and move for easy, precise positioning.

Simple, rugged and well engineered, Scientifica's designs are based on years of experience in the scientific field and are continuously tried, tested and trusted by customers worldwide.



# Compatible

The Post & Platform Mount works in harmony with a wide range of manipulators and other devices. Widely used to support patch clamp and sharp electrode manipulators, they are often used in a pair for two electrode recordings where absolute stability is essential.

Examples of compatible equipment include:

- Scientifica's LBM-7 Manual Manipulator
- Burleigh Patch Clamp Micromanipulators
- Burleigh Solution Switching Manipulators
- and many others.

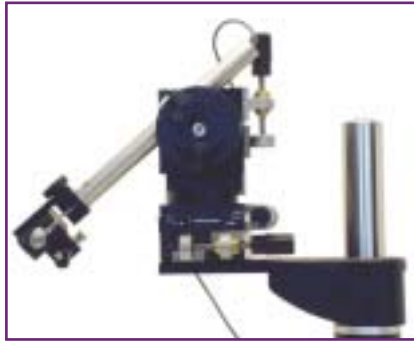

## Key features

- *Solid, durable construction of stainless steel and aluminium*
- *Resists vibration interference with experiments*
- *Height and horizontal angle are fully adjustable*
- *All moveable parts are fitted with quick-release locks*
- *Magnetic or screw-down base*
- *Mechanical stops for perfect replication of position*

# Technical Specifications

<b>Mounting Requirements</b>	
With Screw-Down Base	Metric 25mm or inch spaced tapped holes
With Magnetic Base	Any ferromagnetic surface
<b>Control</b>	Vertical and rotational adjustment
<b>Height</b>	
With Screw-Down Base	393mm (15.5")
With Magnetic Base	420mm (16.5")
<b>Weight</b>	
With Screw-Down Base	4.45kg (9.8 lbs)
With Magnetic Base	8.8kg (19.5 lbs)
<b>Country of Manufacture</b>	UK

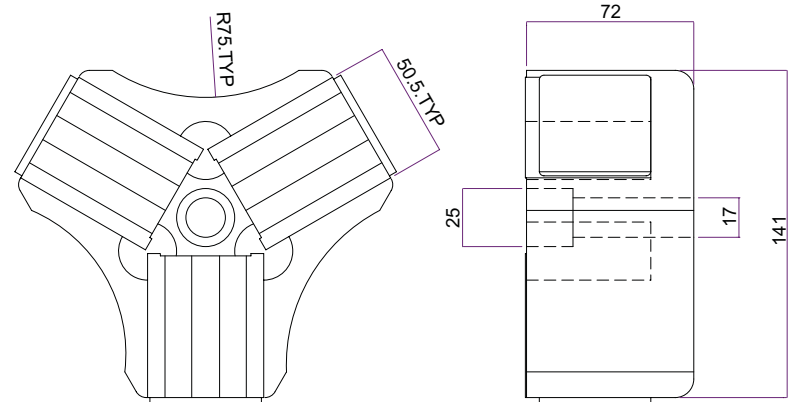
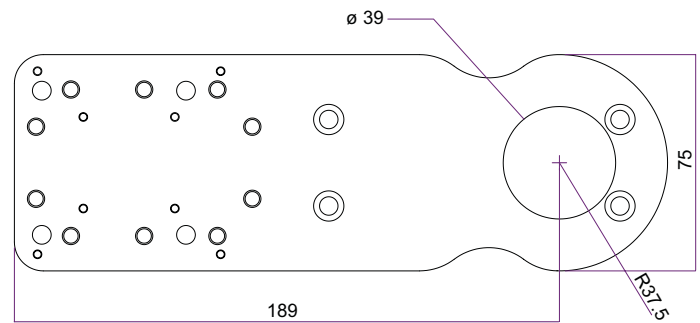
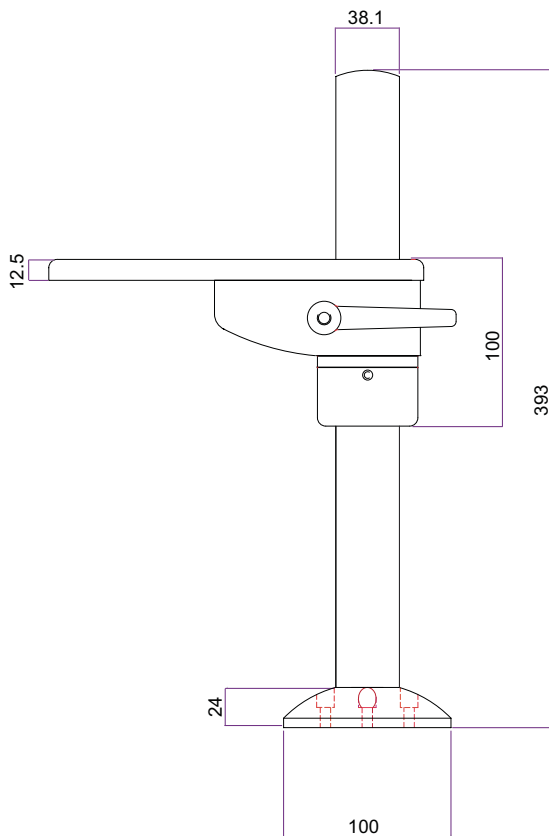

# Ordering Information

To order within the UK and Eire, please contact Scientifica directly. Outside these areas, please contact your local sales representative. Using the part numbers below, please specify your chosen Post and Platform system.

Product	Part No.
Post & Platform with Screw-Down Base	PP-3010-00
Post & Platform with Magnetic Base	PP-3020-00
Screw-Down Base	PP-3015-00
Magnetic Base	PP-3025-00

# Warranty

All Scientifica instruments are sold with a two year warranty to give you complete peace of mind. This covers all defects in manufacturing and materials, providing the system is registered with us within 30 days of delivery. An extended warranty can be purchased if desired after this two year period.

For more information please contact your local distributor or visit our website [www.scientifica.uk.com](http://www.scientifica.uk.com)

SCIENTIFICA LTD, Kingfisher Court, Brambleside, Bellbrook Ind Estate, E Sussex, Uckfield, TN22 1QQ

**Tel:** +44(0)1582 766888

**Email:** [info@scientifica.uk.com](mailto:info@scientifica.uk.com)

**Fax:** +44(0)1582 767888

**Web:** [www.scientifica.uk.com](http://www.scientifica.uk.com)